

**HSF**

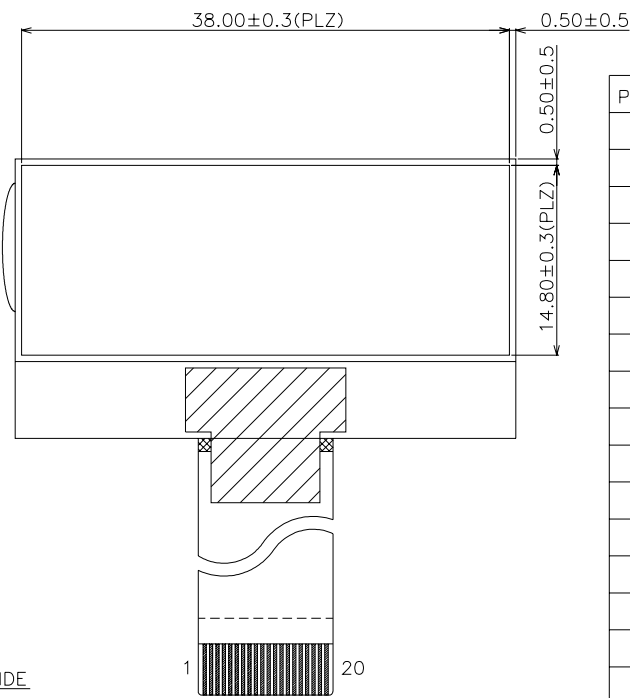

PIN NO.	SYMBOL
1	/CS1B
2	/REST
3	A0
4	SCLK
5	SID
6	VDD
7	VCI
8	VSS
9	VOUT
10	VPP
11	CAP3+
12	CAP1-
13	CAP1+
14	CAP2+
15	CAP2-
16	V0
17	V1
18	V2
19	V3
20	V4

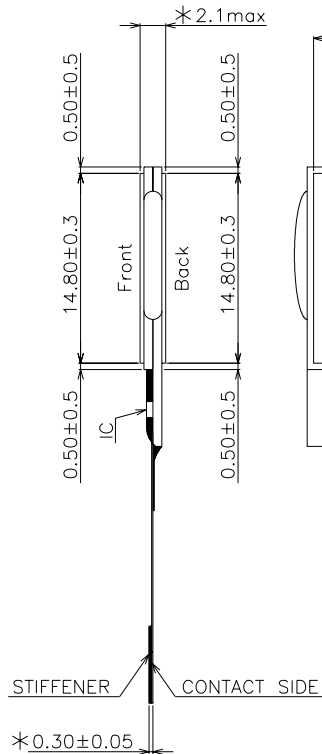
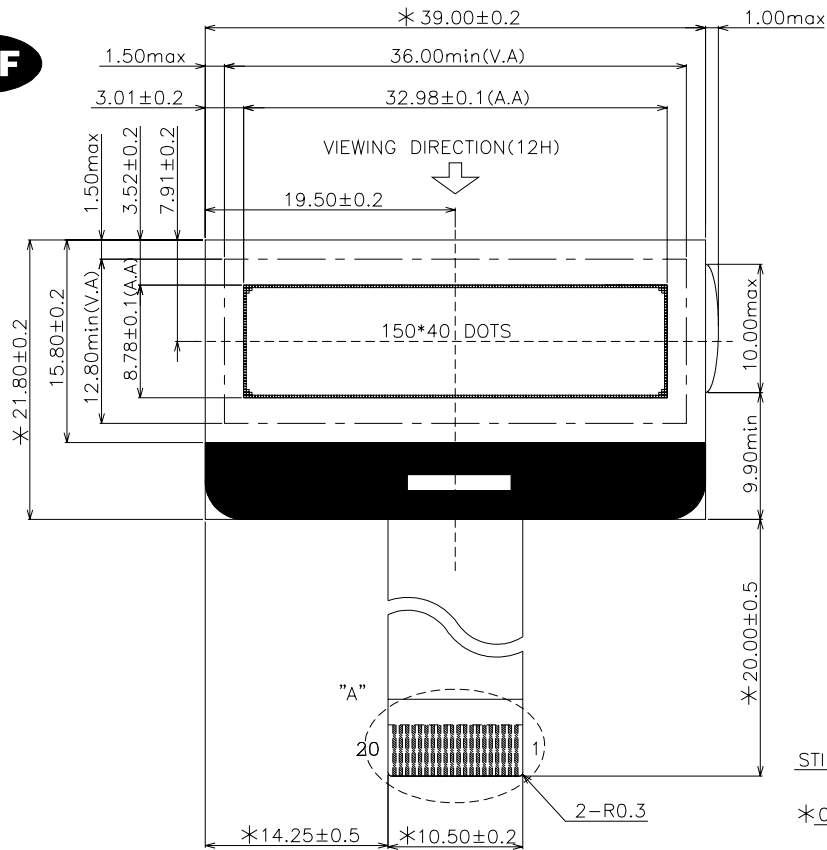
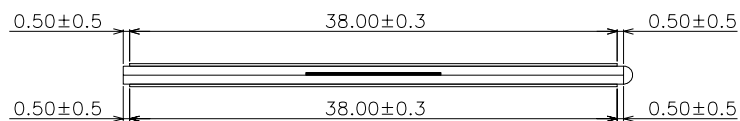

DOT DETAIL:

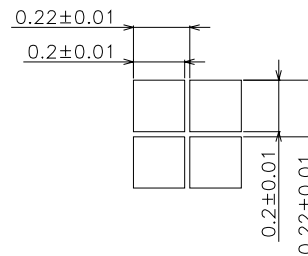

DETAIL A:

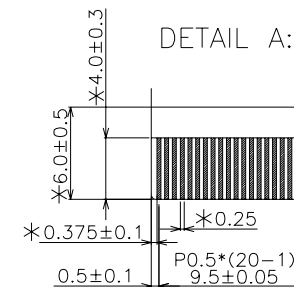

NOTE:

1. DISPLAY TYPE:FSTN
2. DRIVING METHOD: 1/65 DUTY, 1/9 BIAS
3. OPERATING VOLTAGE:VDD=3.3V V0-VSS=9.0V
4. OPERATING TEMP: -30° ~ 60°C
5. STORAGE TEMP: -30° ~ 80°C
6. VIEWING DIRECTION: 12 O'CLOCK
7. POLARIZER MODE: TRANSFLECTIVE/POSITIVE
8. CONNECTION:COG+FPC(小片在上, 磨邊)
9. LCD DRIVE IC:IST3020
10. RohS COMPLIANT
11. DIMENSIONS ARE IN MILLIMETERS AND UNLESS OTHERWISE NOTED ARE ±0.20MM

NOTE:

- 1.UNIT:mm
- 2.SCALE:NTS

REVISES CONTENT		SUN-VIEW TECHNOLOGY CO., LTD					PROJECTION	☉
02	增加重點尺寸標示	CUSTOM						
		DRAWING BY	沈光娥	2018.10.30	ITEM	MD	UNITS	mm
		CHECKED BY			CODE	MD170417002	SCALE	1:1
		APPROVED BY			MODEL	SVG150040BWNC	SHEET	1 OF 2